



# 100 Series Sandwich Valve w/AirTorque Actuator

## Applications

Dispenser Manifolds, Priority Panels, Emergency Isolation and applications where easy service is required.  
Suitable for CNG, Bio-Gas and Nitrogen



SV104-406SDDN-0146 - 1/2 " Sandwich Valve w/AT201 Actuator

## Materials

Item	Description	Material
1	Valve Body	304 Stainless Steel
2	Valve Cap	304 Stainless Steel
3	Seat	Delrin
4	Ball	316 Stainless Steel
5	Stem	316 Stainless Steel
6	Thrust	Delrin

Item	Description	Material
7	O-ring	Nitrile
8	O-ring Backup	Nitrile
9	Gland	Delrin
10	Locking Tab	304 Stainless Steel
11	Half Nut	304 Stainless Steel
12	Sealing Surface O-ring	Nitrile

## Product Information

Standard valve includes actuator mounting bracket and drive dog.

Service kits are easily installed and readily available.  
All products are manufactured under ISO 9001:2008 accredited standards.

Mounting brackets and drive dogs designed to meet standard ISO 5211 pattern, allowing user multiple actuation options.

Handle options available on request.

Peek, Viton seals or user specified options available.

Oasis can create the manifold to your specifications.

## Features & Benefits

Designed for manifold or valve applications where minimizing service down time is critical.

Bolt-in, quick change design which fits into a manifold or uses end caps for your flow control requirements.

Using the proven Oasis floating ball technology the sandwich valve cycles for longer than any other known valve.



# 100 Series Sandwich Valve w/AirTorque Actuator

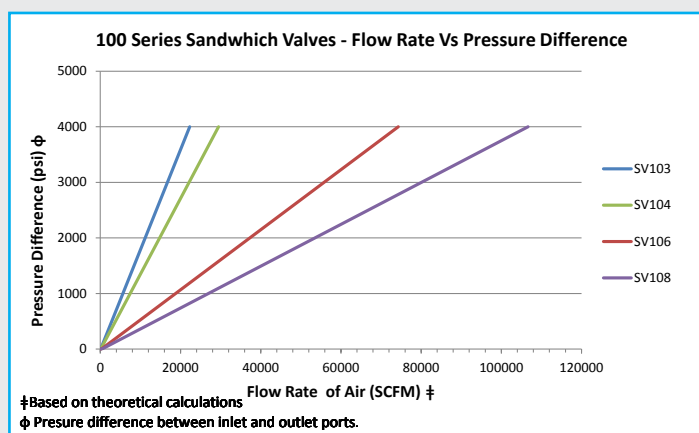

## Dimensions

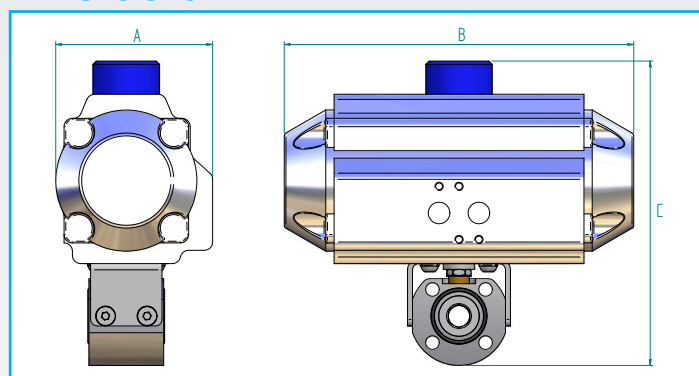

## Dimensions inch (mm)

Part Code	Size	A	B	C	ACT MODEL
SV103-4O6SDDN-0122	3/8"	2.78 (70.5)	5.87 (149)	5.87 (149)	AT051
SV104-4O6SDDN-0124	1/2"	3.27 (83)	6.26 (159)	6.65 (169)	AT101
SV106-4O6ADDN-0146	3/4"	3.74 (95)	8.31 (211)	9.01 (229)	AT201
SV108-4O6SDDN-0148	1"	4.17 (106)	9.76 (248)	9.80 (249)	AT251

## Product Specifications

Part Code	Mass lb (kg)	Min. Operating Pressure bar (psi) *	Max. Operating Pressure bar (psi) **	Min. Temp. °F (°C)	Max. Temp. °F (°C)	Max. Cycles Before Rekit ^	Actuator Supply Pressure bar (psi) ^^	Cv
SV103-4O6SDDN	5 (2.3)	34.5 (500)	410 (6000)	-40 (-40)	185 (85)	100,000	6-8 (87-116)	9.3
SV104-4O6SDDN	8.8 (4)	34.5 (500)	410 (6000)	-40 (-40)	185 (85)	120,000	6-8 (87-116)	12.3
SV106-4O6ADDN	15.7 (7.1)	34.5 (500)	410 (6000)	-40 (-40)	185 (85)	150,000	6-8 (87-116)	31
SV108-4O6SDDN	21.4 (9.7)	34.5 (500)	410 (6000)	-40 (-40)	185 (85)	150,000	6-8 (87-116)	44.5

\* Minimum system pressure the product will hold constant bubble tight seal.

\*\* Maximum pressure at which the product can constantly operate at.

^ It is recommended that the sandwich valve is re-kitted on or before the maximum number of allowable cycles.

^^ Required actuator supply pressure to operate Air Torque actuator.

We reserve the right to modify product specifications without prior notice.